

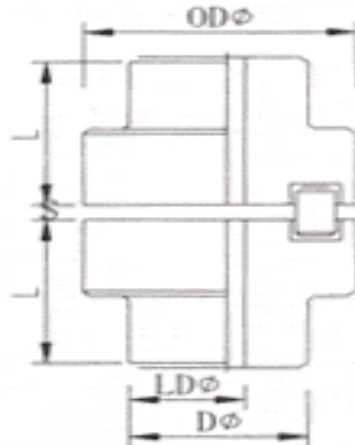

NM TECHNICAL DATA SHEET



Coupling NM Type	Torque Normal NM	Max Speed rpm	Bore Dia		Boss Dia D	Outside Dia	Length L	S gap	Weight Kgs
			Min	Max					
50	12.75	13,500	7	19	33	50	25	2.00	0.48
67	21.58	10,000	9	28	46	67	30	2.50	1.02
82	49.03	8,000	10	32	53	82	40	3.00	1.88
97	102.97	7,000	12	42	69	97	50	3.00	3.54
112	163.77	6,000	14	48	79	112	60	3.50	5.40
128	261.83	5,000	18	55	90	128	70	3.50	8.10
148	408.93	4,500	22	65	107	148	80	3.50	13.50
168	681.56	4,000	28	75	126	170	90	3.50	10.50
194	1637.71	3,500	32	85	140	194	100	3.50	26.30

NM coupling consists of two hubs and flexible ring able to compensate all types of shaft misalignments. The flexible rings are made of Nitile rubber (NBR) which have a high internal damping characteristic which enable to absorb and dampen torsional vibrations, operate effectively in temperature range of -40C to +100C The NBR material also resists oil, dirt, grease, moisture, ozone and many chemical solvents.