

Pitch 27.9 mm (1.10 in.)



uni OWL – the heat and wear resistant belt with minimal friction surface

uni OWL 1.1 in. pitch belt is created for applications requiring large open area.

Together with the material properties the open belt design with minimal contact surface provides heat resistance, easy plastic film release and good airflow.

The uni OWL belt has improved performance in the following industries/applications:

- Shrinking tunnels without the need for lubrication and without black wear debris
- Bakery industries, including cooling lines
- Fruit and vegetables application including dewatering and cooling lines

Product features and operational benefits:

- Minimal friction and contact between product and belt
- Large open area for easy drainage/airflow (66% open belt)
- Special material allows operating temperature of 180°C (356°F) and makes the belt resist peak temperature up to 230°C (446°F)
- Patented nonstick belt surface

Standard Selection

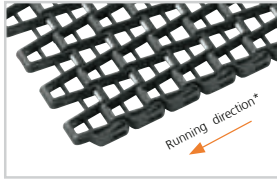

* Travel in both directions is possible. uni-chains recommends this travel direction.

uni OWL
Surface opening 66%

Dimensional Sketch

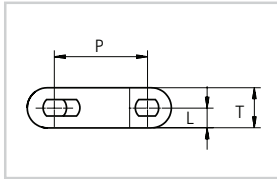

uni OWL

Dimensions

	mm	in.
P	27.9	1.10
L	5.5	0.22
T	11.0	0.43

- Straight running
- 27.9 mm (1.10 in.)
- $\varnothing 4.0$ mm (0.16 in.)
- See page 8
- 40 mm (1.57 in.)
- See page 54
- See page 172

Alternatives

- PA6.6** **B**

Standard Materials and Colors

Type	Standard materials and colors	Standard pin materials and colors	Standard lock materials and colors
uni OWL	PA6.6 GFH K B	SS304	PA6.6 GFH K B
	PP W B	PBT LG	PP W B

Alternative pin materials and colors:

PA6.6 **B**

Standard Bricklaid Belt Widths (See next page for Single Link® widths)

mm	in.	mm	in.	mm	in.	mm	in.
305	12.0	645	25.4	984	38.7	1323	52.1
339	13.3	679	26.7	1018	40.1	1357	53.4
373	14.7	713	28.1	1052	41.4	1391	54.8
407	16.0	746	29.4	1085	42.7	1425	56.1
441	17.4	780	30.7	1120	44.1	1459	57.4
475	18.7	814	32.0	1154	45.4	1493	58.8
509	20.0	848	33.4	1188	46.8	1527	60.1
543	21.4	882	34.7	1222	48.1	1561	61.5
577	22.7	916	36.1	1255	49.4	1595	62.8
611	24.1	950	37.4	1289	50.7	1629	64.1

Note: Above widths are belts in PA6.6 GFH. In PP material the belt width is 1% smaller.
On above belt width values, the belt width tolerance on standard materials is +0/-0.4% at 23°C/73°F.

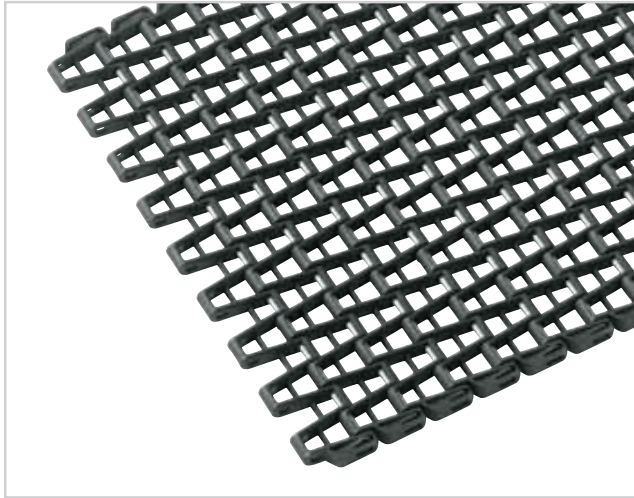
uni OWL Single Link®

uni OWL Single Link® is available in the following standard widths:

Center module are used in the middle of the belt.

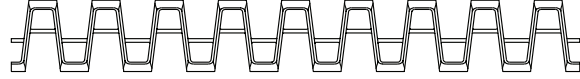
 PA6.6 GFH: K1200 (305.4 mm (12.02 in.))
 PP: K1200 (302.5 mm (11.91 in.))

The Both link is split in two and used as the outer part of the belt.

 PA6.6 GFH: K1200 (305.2 mm (12.02 in.))
 PP: K1200 (302.2 mm (11.90 in.))

uni OWL Single Link® standard materials and colors see page 52.

uni OWL Single Link® Belt Widths

Belt type and widths	K1200 Center		K1200 Both	
	PA6.6 GFH 305.4 mm (12.02 in.)	PP 302.5 mm (11.91 in.)	PA6.6 GFH 305.2 mm (12.02 in.)	PP 302.2 mm (11.90 in.)
uni OWL	X	X	X	X

Belt Weights

Belt material	PA6.6 GFH		PP	
	SS		PBT	
Pin material	kg/m ²	lb/ft ²	kg/m ²	lb/ft ²
uni OWL	7.7	1.58	4.6	0.94

Permissible Tensile Strength

Belt material	PA6.6 GFH		PP	
	SS		PBT	
Pin material	N/m	lbf/ft	N/m	lbf/ft
uni OWL	12000	822	8000	548

Standard Sprockets

No. of teeth	Pitch diameter		Overall diameter		Hub diameter		Bore		Reference no. plastic
	mm	in.	mm	in.	mm	in.	mm	in.	
9	81.7	3.22	83.4	2.05	-	-	ø18.0/40.0	ø0.71/1.57	663PA6OWL091111N00
							sq 25.4	sq 1.00	663PA6OWL091111N00I100S
							sq 30.0	sq 1.18	663PA6OWL091111N0M030S
11	99.4	3.91	101.9	4.01	-	-	ø18.0/50.0	ø0.71/1.97	663PA6OWL111111N00
							sq 38.1	sq 1.50	663PA6OWL111111N00I150S
							sq 40.0	sq 1.57	663PA6OWL111111N00M040S
13	117.2	4.61	120.2	4.73	-	-	ø18.0/70.0	ø0.71/2.76	663PA6OWL131111N00
							sq 38.1	sq 1.50	663PA6OWL131111N00I150S
							sq 40.0	sq 1.57	663PA6OWL131111N00M040S
15	135.0	5.31	138.4	5.45	-	-	ø18.0/70.0	ø0.71/2.76	663PA6OWL151111N00
							sq 38.1	sq 1.50	663PA6OWL151111N00I150S
							sq 40.0	sq 1.57	663PA6OWL151111N00M040S
							sq 50.8	sq 2.00	663PA6OWL151111N00I200S

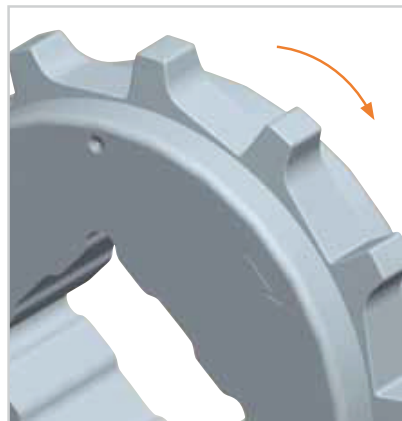

Other sprocket sizes are available upon request.

Two-part sprockets are available upon request.

Placement of Wearstrips and Sprockets

No. of teeth	Minimum B-dimension		Wearstrip distance A	
	mm	in.	mm	in.
9	46.7	1.84	32.85	1.29
11	55.5	2.18	42.0	1.65
13	64.3	2.53	51.1	2.01
15	73.2	2.88	60.1	2.37

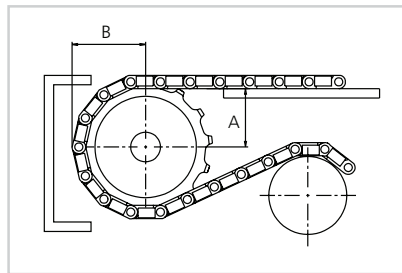
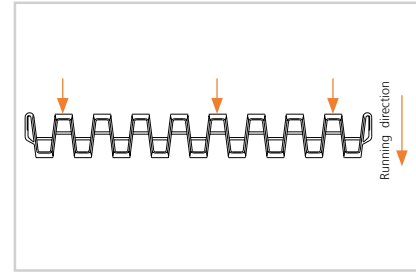
Placing of Sprockets

Max. Load per Sprocket

Belt material	PA6.6 GFH		PP	
	N	lbf	N	lbf
uni OWL	1200	270	800	180